

300 Atlantic Street

In the Heart of Downtown Stamford, CT



Prime Retail Space Available
Join California Tortilla, Charles Schwab & Fidelity

300 Atlantic Street

- In the heart of downtown Stamford at the intersection of Atlantic Street & Tresser Boulevard
- Located within immediate walking distance to the Stamford Train Station
- Walk to over 50 shops, banks and restaurants
- Close proximity to I-95
- Adjacent to Stamford Town Center
- Surrounded by over 6,600,000sf of office within a three-block-radius
- Dedicated valet lane opportunity
- Strong street presence

Space A	
Term	Negotiable
Size	1,801sf
Outdoor Seating	35+
Frontage	Wraparound 150'

Site Plan

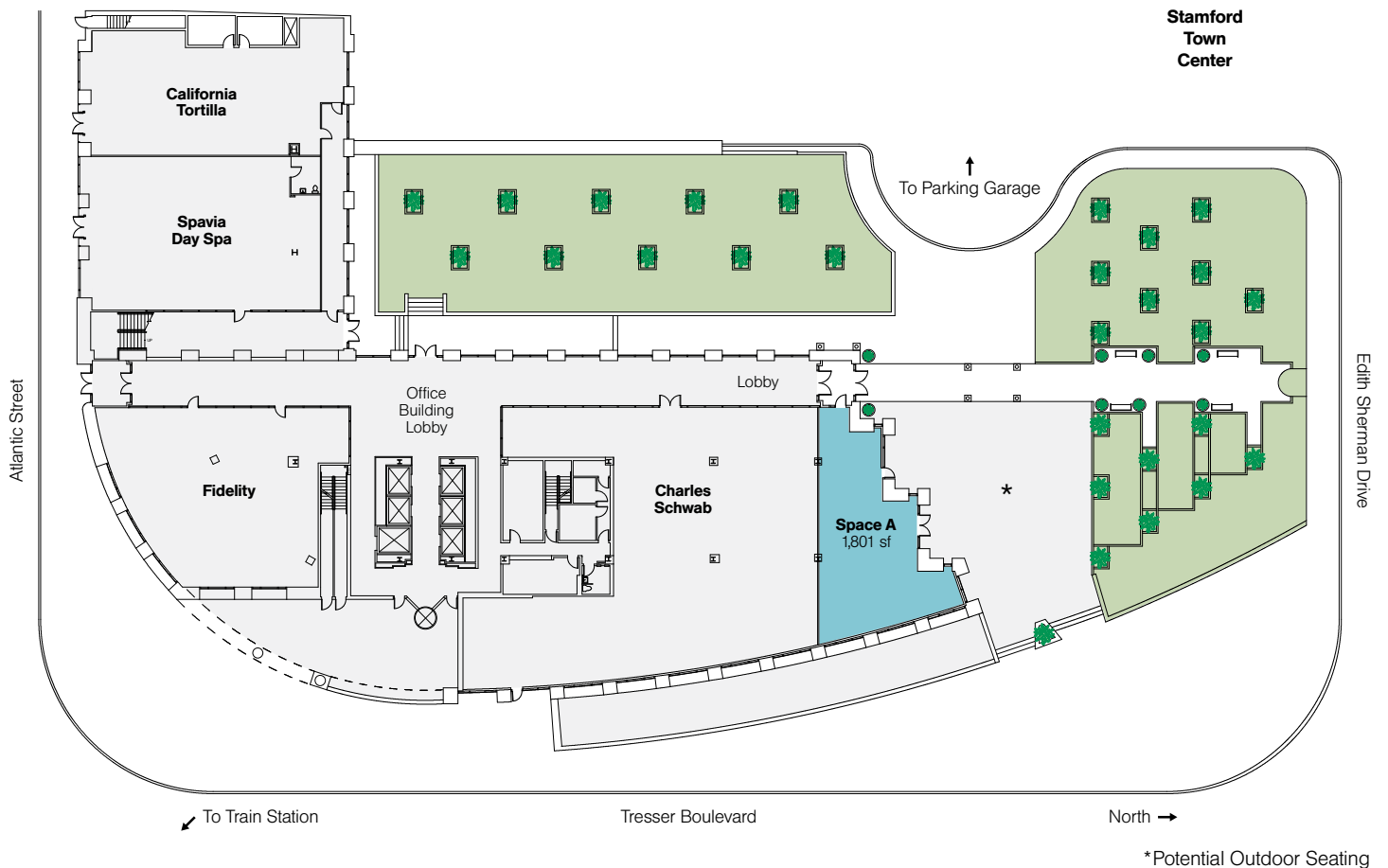

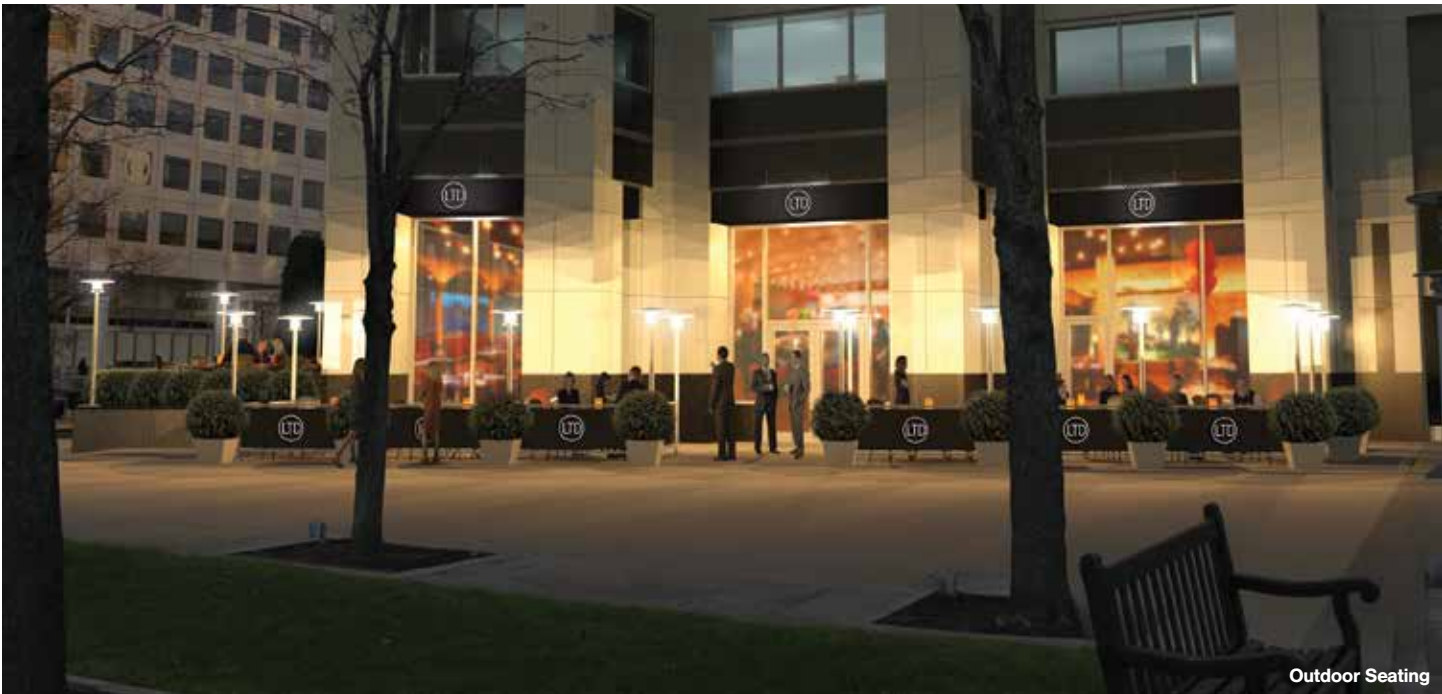

Outdoor Seating



Proposed Rapid Takeout Opportunity