

300 Atlantic Street

In the Heart of Downtown Stamford, CT



2 Prime Retail Spaces Available

Prominent Frontage | Outdoor Seating | Direct Lobby Access

300 Atlantic Street

- In the heart of downtown Stamford at the intersection of Atlantic Street & Tresser Boulevard
- Located within immediate walking distance to the Stamford Train Station
- Walk to over 50 shops, banks and restaurants
- Close proximity to I-95
- Adjacent to Stamford Town Center
- Surrounded by over 6,600,000sf of office within a three-block-radius
- Dedicated valet lane opportunity
- Strong street presence

Space A		Space B	
Term	Negotiable	Term	Negotiable
Size	3,520sf	Size	4,170sf
Outdoor Seating	35+	Frontage	42'
Frontage	Wraparound 150'		

Site Plan

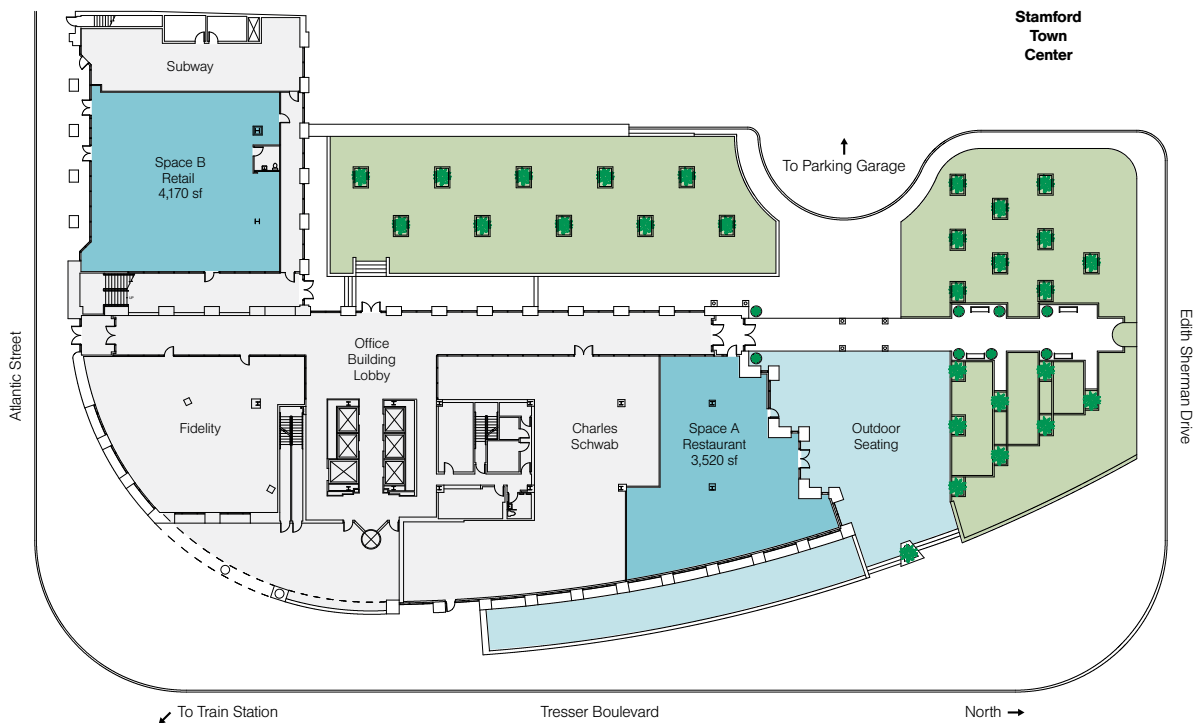

Area Demographics

Radius	Daytime Population	Households	Average Household Income
1 mile	52,279	18,061	\$82,031
3 miles	124,617	49,563	\$129,358
5 miles	169,637	66,651	\$148,541

Note: 25,000 vehicles per day pass by 300 Atlantic Street.



Outdoor Seating



Frontage Along Tresser Boulevard



Proposed Rapid Takeout Opportunity