

17 State Street

Full Floor - 14,900 RSF

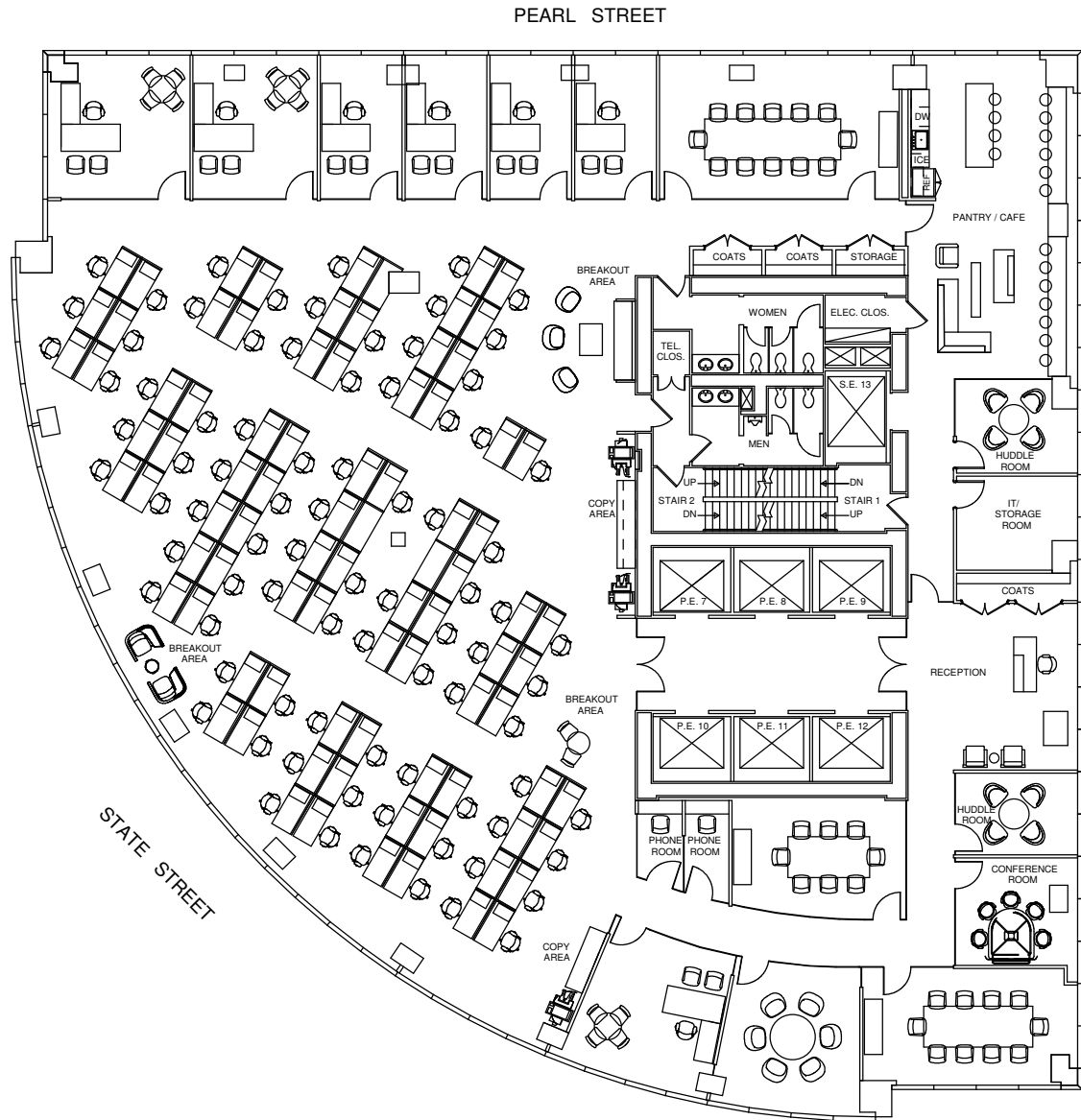

| SPACE TYPE | PROVIDED |
|------------------------|---------------|
| RECEPTION | 1 |
| EXECUTIVE OFFICE | 2 |
| PRIVATE OFFICE | 4 |
| WORKSTATIONS (30X60) | 86 |
| TOTAL HEADCOUNT | 93 PPL |
| CONFERENCE ROOM (12) | 1 |
| CONFERENCE ROOM (10) | 1 |
| CONFERENCE ROOM (8) | 1 |
| CONFERENCE ROOM (6) | 1 |
| CONFERENCE ROOM (5) | 1 |
| HUDDLE ROOM (4) | 2 |
| PHONE ROOM | 2 |
| BREAK OUT AREA | 5 |
| PANTRY | 1 |
| COPY AREA | 2 |
| COAT CLOSET | 4 |
| IT/STORAGE ROOM | 1 |

Date Printed: 10/26/2017



17 State Street

Full Floor - 14,900 RSF

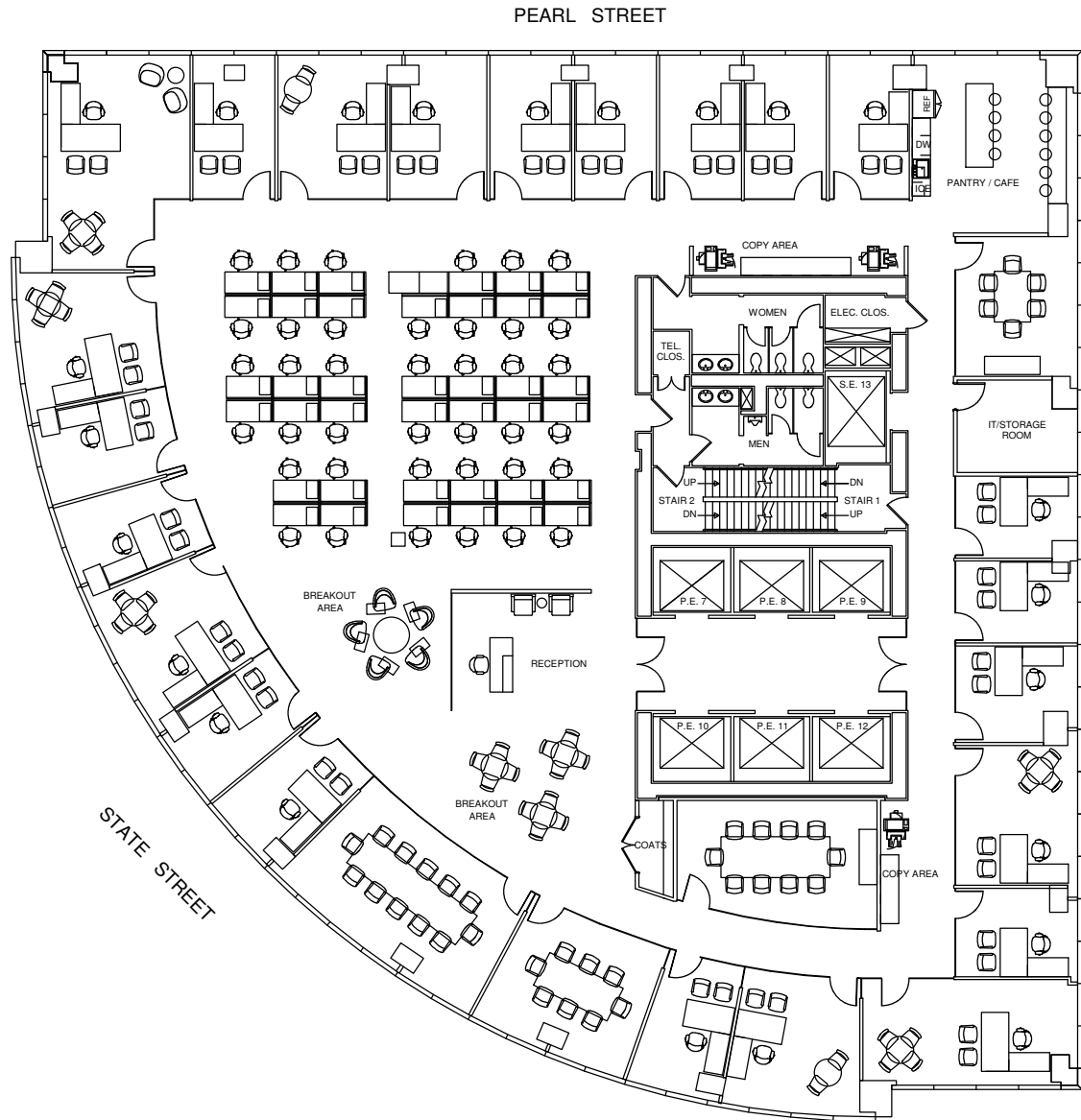

| SPACE TYPE | PROVIDED |
|------------------------|---------------|
| RECEPTION | 1 |
| EXECUTIVE OFFICE | 6 |
| PRIVATE OFFICE | 17 |
| WORKSTATIONS (30X60) | 39 |
| TOTAL HEADCOUNT | 63 PPL |
| CONFERENCE ROOM (12) | 2 |
| CONFERENCE ROOM (6) | 2 |
| BREAK OUT AREA | 2 |
| PANTRY | 1 |
| COPY AREA | 2 |
| COAT CLOSET | 1 |
| IT/STORAGE ROOM | 1 |

17 State Street

Full Floor - 14,900 RSF

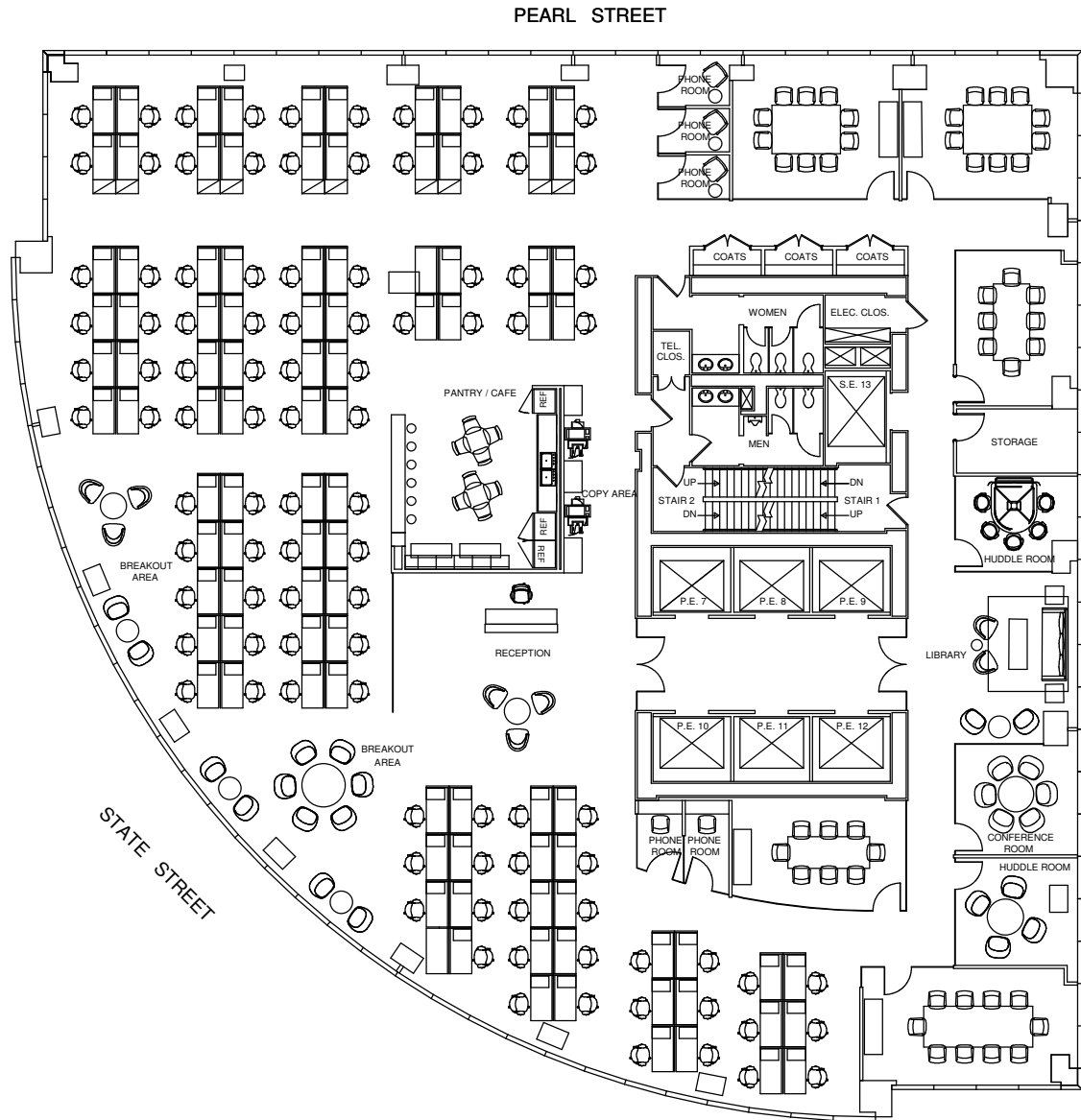

| SPACE TYPE | PROVIDED |
|----------------------|----------|
| RECEPTION | 1 |
| WORKSTATIONS (30x60) | 100 |
| TOTAL HEADCOUNT | 101 PPL |
| CONFERENCE ROOM (10) | 3 |
| CONFERENCE ROOM (8) | 2 |
| CONFERENCE ROOM (6) | 2 |
| Huddle Room (4-5) | 2 |
| PHONE ROOM | 5 |
| BREAK OUT AREA | 2 |
| PANTRY / CAFE | 1 |
| COAT CLOSET | 3 |
| IT/STORAGE ROOM | 1 |
| COPY AREA | 1 |



State Street

RFR



