

1231

market

street

downtown

san francisco

ca

HOTEL

whitcomb

– the coolest
historic hotel in
san francisco



welcome to hotel whitcomb

fully committed to mid-markets transformational renaissance



fall in love not in line

progress

exchange

unconventional

pulse

Open for more than 100 years, Hotel Whitcomb is no stranger to progress. The times change, but a forward-thinking approach and a vision that looks towards the future keeps the Hotel Whitcomb ahead of the curve. Growing up with the neighborhood, the Hotel implements a modern, adaptive attitude with a fundamental understanding of history, place, and purpose.

Fostering connections and instilling a sense of community between visitor and local; Hotel Whitcomb and the city at large. The hotel strives to provide a social, creative, and entrepreneurial hub of Mid-Market. Here ideas are given a platform.

Hotel Whitcomb is never about the expected or conventional. It's not that we reject societal norms, it's just that we forge our own path and march to the beat of our own drums. As the hotel furthest up Market Street, it's no surprise we prefer the independent attitude of Hayes Valley and The Mission to our posh, neighbors down the street.

With a knack for entertaining, the Hotel Whitcomb creates its own energy. Playing host to authentic San Francisco experiences, the Hotel prides itself on the ability to offer live performances as well as direct access to nearly any experience one might want, either under our roof or within a short walk or ride.



proadressive

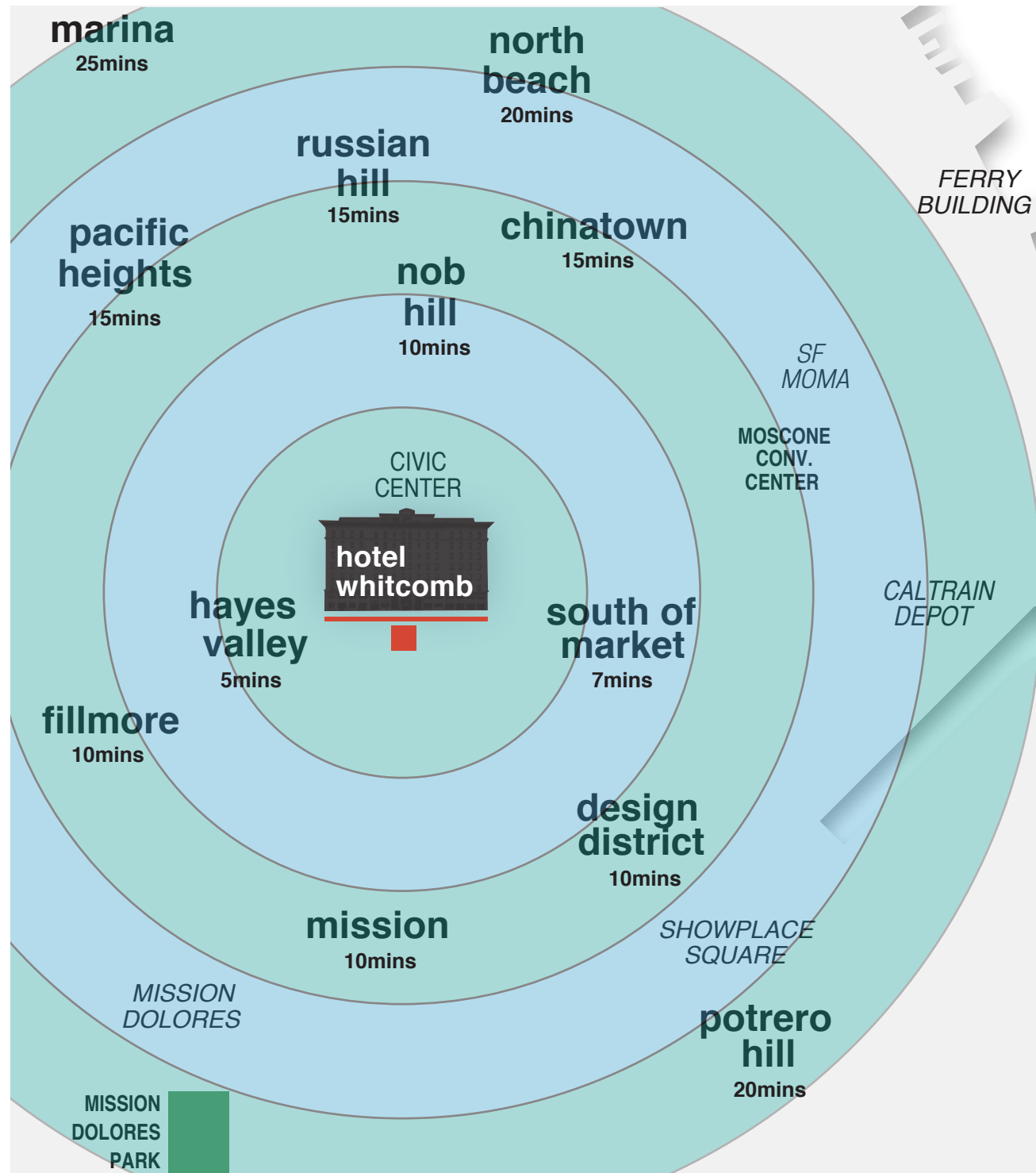

san francisco bay

live sf unfiltered

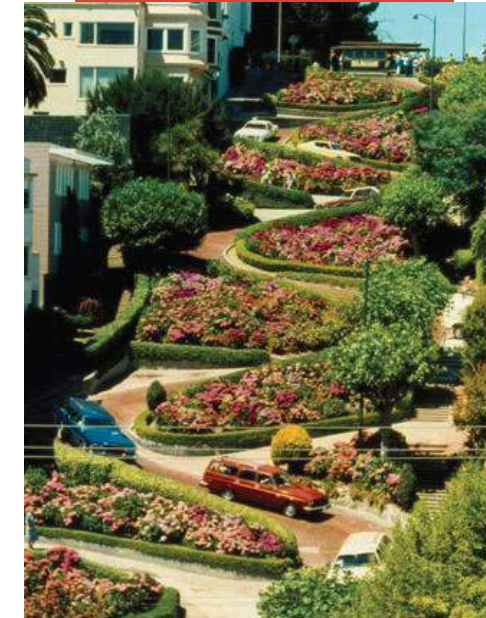

Through the rise, fall and current resurgence of Mid-Market, Hotel Whitcomb understands the need for constant evolution, mirroring the transformation of the community and neighborhood surrounding it.

Just down the block you'll find the headquarters of some of today's most innovative and recognizable tech & social media companies; Twitter and Uber. The Whitcomb is easily accessible by public transport & less than a 30 minute drive to San Francisco's International Airport. Exit the hotel and you'll find yourself near Hayes Valley, South of Market and Union Square, with plenty of eclectic shops, diverse eateries & major attractions that make San Francisco one of the best destinations in the world.



– tap into
the moment

market street

hotel whitcomb

BE HEARD. HERE.

harness the energy

always active, always worthy



availabilities



market st mixed & remastered

eclectic

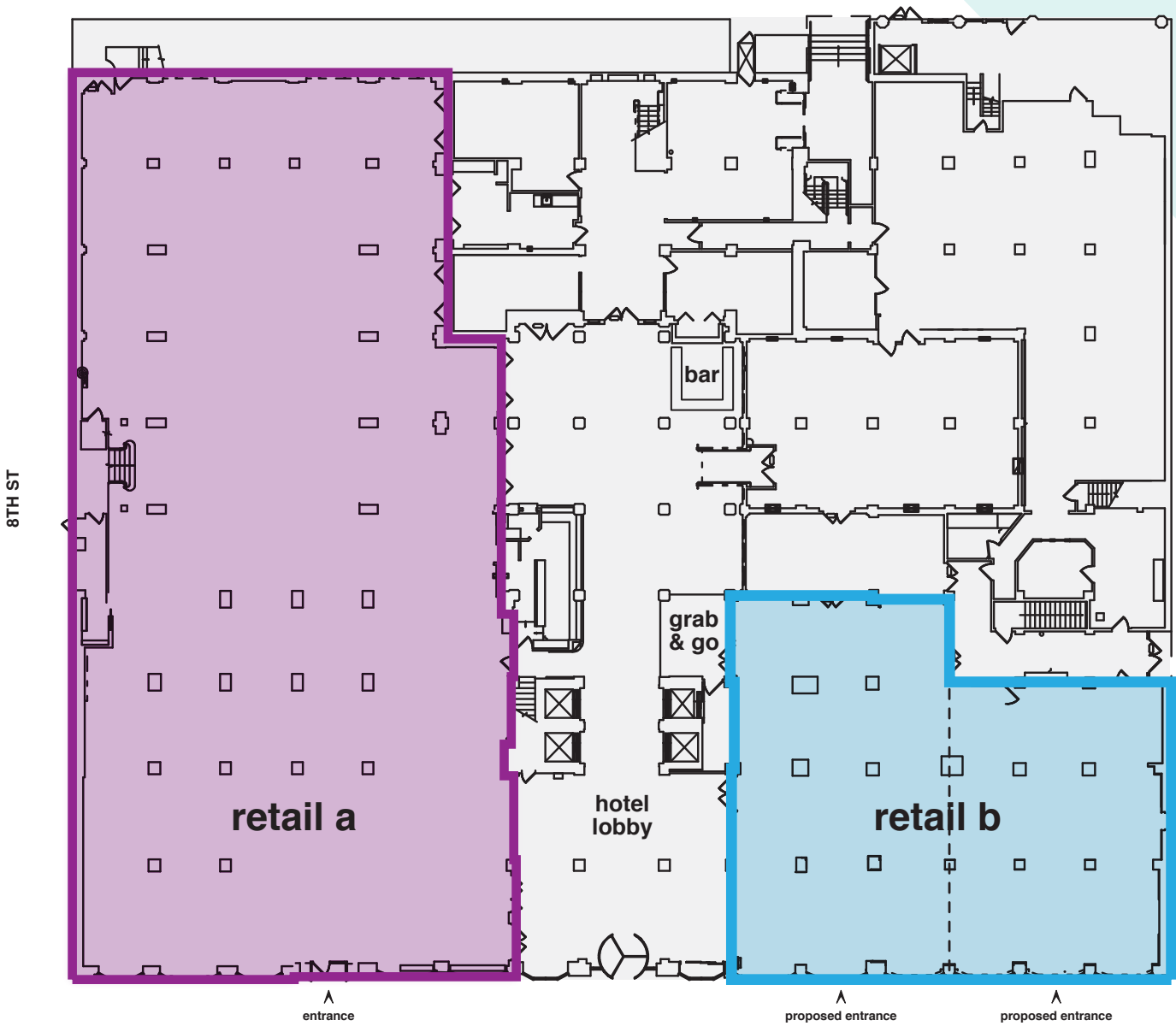

ground 12,553 sf
mezzanine 9,967 sf
80 feet of frontage on market
* divisions available

ground 4,948 sf
80 feet of frontage on market
* divisions available

retail a

available q3 2019

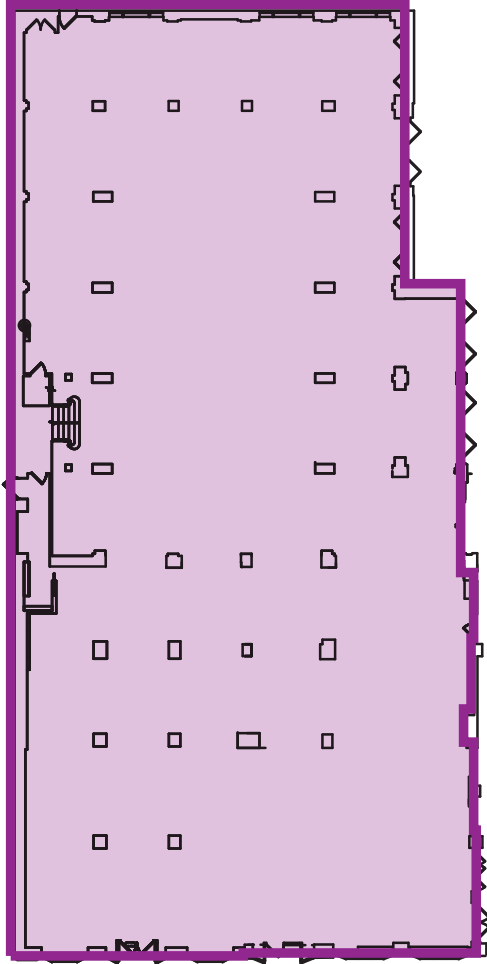

ground

12,553 sf

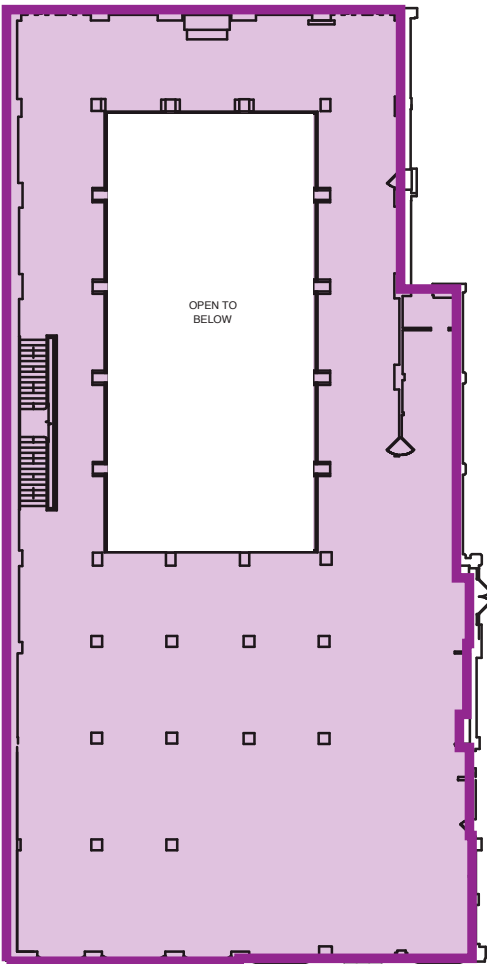

mezzanine

9,967 sf



80' Frontage On Market Street | 16' Ceiling Height at Grade | Delivered White Box

retail b

available q3 2019

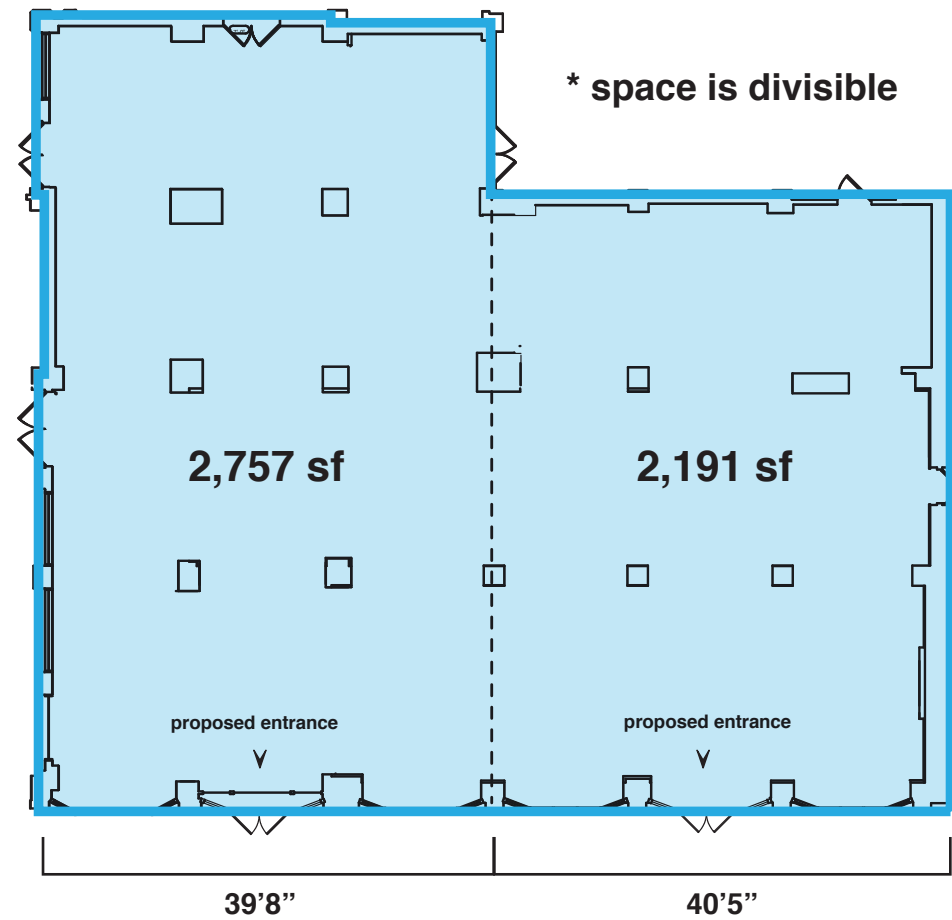

4,948 sf total



80' Frontage On Market Street | 16' Ceiling Height at Grade | Delivered White Box

hotel meets community

part hotel, part short term stay, part entertainment collective

always
a scene

from
shared
rooms



— live
shows



— urban workshop
for the 21st century



hangout by day



a voice for sf



— entertainment
at night



bring style
back to the
streets

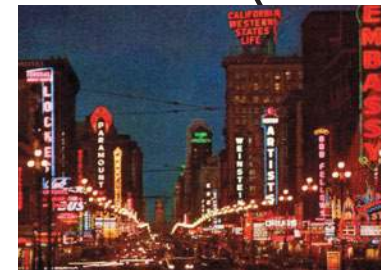

showcase
local makers



— to
extended
stays

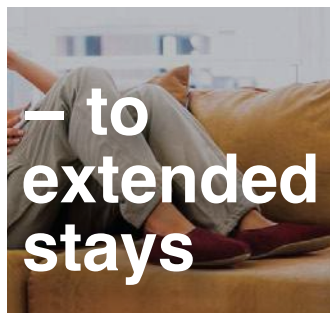

— liquid
conversations



1231

market

street

downtown

san francisco

ca

HOTEL

whitcomb contact

kazuko y. morgan

VICE CHAIRMAN

DIRECT: +1 415 773 3546

KAZUKO.MORGAN@CUSHWAKE.COM

kelly vinson

DIRECTOR

DIRECT: +1 415.658.3652

KELLY.VINSON@CUSHWAKE.COM

mary kate banchero

DIRECTOR

DIRECT: +1 415 658 3641

MARYKATE.BANCHERO@CUSHWAKE.COM